



# Application for a clearing permit (purpose permit)

Environmental Protection Act 1986 s 51E

## FORM C2

Clearing of native vegetation is prohibited in Western Australia except where a clearing permit has been granted or an exemption applies. A person who causes or allows unauthorised clearing commits an offence.

CPS No.

Department of Water and Environmental Regulation

25 SEP 2018

Date stamp

RECORDS

### Part 1 Assessment under the EPBC bilateral agreement

The native vegetation clearing processes under Part V of the Environmental Protection Act 1986 (EP Act) have been accredited by the Commonwealth of Australia under the Environment Protection and Biodiversity Conservation Act 1999 (EPBC Act) and can be assessed under an assessment bilateral agreement.

To be assessed under the assessment bilateral agreement, the proposed clearing action must be referred to the Commonwealth under the EPBC Act prior to submitting this application form and Annex C7 must also be completed.

For further information see Annex C7 and A guide to native vegetation clearing processes under the assessment bilateral agreement available at [www.der.wa.gov.au](http://www.der.wa.gov.au).

Do you want your proposed clearing action assessed in accordance with, or under, an EPBC Act Accredited Process such as the assessment bilateral agreement?

Yes  No Proceed to Part 2

Has the proposed clearing action been referred to the Commonwealth of Australia under the EPBC Act?

Yes EPBC Number

No It cannot be assessed under an Accredited Process until it has been referred to the Commonwealth. Proceed to Part 2.

Has a decision been made under the EPBC Act as to whether or not the proposed clearing action is a controlled action?

Yes  No Proceed to Part 2

Is the proposed clearing action a controlled action under the EPBC Act?

No It cannot be assessed under an Accredited Process, proceed to Part 2

Yes Complete and attach the requirements of Annex C7 to this completed form

List the controlling provisions identified in the notification of the controlled action decision

Annex C7 is complete and the required supporting information is attached

### Part 2 Land details

The location of the land where clearing is proposed must be accurately described.

FILE REFERENCE

Land description: volume and folio number, lot or location number(s), Crown lease or reserve number, pastoral lease number or mining tenement number of all properties.

1. ROAD RESERVE (DARKAN MOODIARRUP ROAD) 2018-19
2. ROAD RESERVE (BOWELLING-DURANILLIN ROAD) 2018-19
3. ROAD RESERVE (WILLIAMS DARKAN ROAD) 2022-23
4. ROAD RESERVE (DARKAN MOODIARRUP ROAD) 2019-20
5. ROAD RESERVE (BOWELLING DURANILLIN ROAD) 2020-21

Local government area

SHIRE OF WEST ARTHUR

### Part 3 Proposal

An aerial photograph or map with a north arrow must be attached, clearly marking the area proposed to be cleared or

if you have the facilities, a digital map on CDROM of the area to clear as an ESRI shapefile with the following properties:

- Geometry type: polygon shape
- Coordinate system: GDA 1994 (Geographic latitude/longitude)
- Datum: GDA 1994 (Geocentric Datum of Australia 1994).

Total area of clearing proposed (hectares)

1) 0.8 2) 0.9 3) 5.0 4) 0.6 5) 3.0

Proposed method of clearing or final land use

MECHANICAL REMOVAL

Period within which clearing is proposed to be undertaken, e.g. May 2013 – June 2018

OCTOBER 2018 – OCTOBER 2024

Purpose of clearing

- 1) WIDENING OF ROAD
- 2) WIDENING OF ROAD
- 3) WIDENING OF ROAD
- 4) WIDENING OF ROAD
- 5) WIDENING OF ROAD

Has this clearing application or any related matter been referred to the Environmental Protection Authority (EPA)  Yes  No



Part 4 Applicant									
<p>To apply for a permit you must either be:</p> <ul style="list-style-type: none"> <li>the landowner</li> <li>or</li> <li>have the authority of the landowner to access the land and undertake the clearing.</li> </ul>	<p>Are you applying as an individual, a company or an incorporated body? Enter details for one only (please print).</p> <p>SHIRE OF WEST ARTHUR ABN 969 1232 0795</p>								
<p><b>Ownership of land</b></p> <p>A landowner can be:</p> <ul style="list-style-type: none"> <li>a person who holds the Certificate of Title</li> <li>a person who is the lessee of Crown land</li> <li>or</li> <li>a public authority that is responsible for care of the land.</li> </ul>	<p>Form of ownership:</p> <p><input type="checkbox"/> Certificate of Title (please attach a copy of the certificate and all associated encumbrances with the application, available from the Western Australian Land Information Authority – Landgate)</p> <p><input type="checkbox"/> Pastoral lease (please attach a copy of the lease and all associated encumbrances with the application)</p> <p><input type="checkbox"/> Mining lease</p> <p><input checked="" type="checkbox"/> Public authority that has care, control or management of the land</p> <p><input type="checkbox"/> Other form of lease, land tenure or specific arrangement. Please state:</p> <p></p>								
<p><b>Authority to access land</b></p> <p>Please specify the applicant's authority to access land to be cleared. For example, a letter from Department of Planning, a statutory power or letter of authority from the landowner.</p> <p>Note: the letter of authority must explicitly state the applicant has authority to clear on the said land.</p>	<p>State nature of authority to access land (please attach copy of authority)</p> <p>ALL FIVE LOCATIONS ARE VESTED WITH THE SHIRE OF WEST ARTHUR FOR CARE, CONTROL AND MANAGEMENT</p>								
<p><b>Proposed permit holder details</b></p> <p>*If applying as a company or incorporated body, please also supply the registered business office address.</p>	<table border="0"> <tr> <td data-bbox="501 1444 959 1576"> <p>Given names, family name and title (Mr, Mrs, Ms, etc.)</p> <p></p> </td> <td data-bbox="995 1444 1508 1576"> <p>Position title/Company</p> <p></p> </td> </tr> <tr> <td colspan="2" data-bbox="501 1585 1508 1711"> <p>Postal/Business address* (for future correspondence)</p> <p></p> </td> </tr> <tr> <td data-bbox="501 1720 959 1805"> <p>Fixed telephone number</p> <p></p> </td> <td data-bbox="995 1720 1508 1805"> <p>Mobile telephone number</p> <p></p> </td> </tr> <tr> <td data-bbox="501 1814 959 1890"> <p>Fax number</p> <p></p> </td> <td data-bbox="995 1814 1508 1890"> <p>Email address</p> <p></p> </td> </tr> </table>	<p>Given names, family name and title (Mr, Mrs, Ms, etc.)</p> <p></p>	<p>Position title/Company</p> <p></p>	<p>Postal/Business address* (for future correspondence)</p> <p></p>		<p>Fixed telephone number</p> <p></p>	<p>Mobile telephone number</p> <p></p>	<p>Fax number</p> <p></p>	<p>Email address</p> <p></p>
<p>Given names, family name and title (Mr, Mrs, Ms, etc.)</p> <p></p>	<p>Position title/Company</p> <p></p>								
<p>Postal/Business address* (for future correspondence)</p> <p></p>									
<p>Fixed telephone number</p> <p></p>	<p>Mobile telephone number</p> <p></p>								
<p>Fax number</p> <p></p>	<p>Email address</p> <p></p>								



<p><b>Contact details</b></p> <p>Person with whom the Department of Environment Regulation or Department of Mines and Petroleum should liaise concerning the clearing application.</p> <p>*If applying as a company or incorporated body, please also supply the registered business office address.</p>	<p><input checked="" type="checkbox"/> Contact details are the same as above or:</p> <p>Given names, family name and title (Mr, Mrs, Ms, etc.) <span style="float: right;">Position title/Company</span></p> <p><input type="text"/> <span style="float: right;"><input type="text"/></span></p> <p>Postal/Business address*</p> <p><input type="text"/></p> <p>Fixed telephone number <span style="float: right;">Mobile telephone number</span></p> <p><input type="text"/> <span style="float: right;"><input type="text"/></span></p> <p>Fax number <span style="float: right;">Email address</span></p> <p><input type="text"/> <span style="float: right;"><input type="text"/></span></p>
--	--

**Part 5 Declaration and signature**

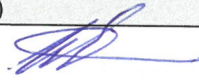
<p>For your application to be accepted, it must be signed either on behalf of the company or as an individual.</p> <p>By signing this form you are declaring that the statements on this form are true and correct.</p> <p>The department in accepting this form accepts you are a person duly authorised to sign for and on behalf of the body corporate in applying for and in holding a permit.</p> <p>Knowingly providing false or misleading information is an offence under section 112 of the <i>Environmental Protection Act 1986</i> and may incur a penalty of up to \$50,000.</p>	<p>Please indicate if you are signing as an individual or a company:</p> <p><input type="checkbox"/> <b>An individual.</b> If an individual landowner is applying, <b>all landowners</b> must sign this form.</p> <p><input type="checkbox"/> <b>A company.</b> A person duly authorised to sign for and on behalf of the body corporate must sign this form. A company must be a legal entity and provide an Australian Company Number (ACN). Please note Australian Business Number (ABN) is not sufficient.</p> <p><input checked="" type="checkbox"/> <b>Other entity formed at law.</b> Provide details: <input type="text" value="LOCAL GOVERNMENT"/></p> <p>Signature(s) <span style="float: right;">Date</span></p> <p>(1)  <span style="float: right;">18.9.2018</span></p> <p>(2) <input type="text"/></p> <p>Print name(s) <span style="float: right;">Common seal (if used)</span></p> <p>(1) BILL OWEN <span style="float: right;"><input type="text"/></span></p> <p>(2) <input type="text"/></p> <p>Position (e.g. director, CEO etc.)</p> <p>(1) WORKS MANAGER</p> <p>(2) <input type="text"/></p> <p>Company name/ACN or other entity (incorporation etc.)</p> <p>SHIRE OF WEST ARTHUR</p>
--	---

**Part 6 Prescribed fee**

<p>Make cheques or money orders payable to:</p> <p>Department of Environment Regulation (for all clearing purposes other than mining and petroleum activities) or Department of Mines and Petroleum (for mining and petroleum clearing activities under the Mining Act, various Petroleum Acts or State Agreement Acts).</p> <p>To make payment with a credit card, please complete Form C3 and attach to this form.</p>	<p>A \$200 fee is required for all purpose permit applications.</p> <p style="text-align: right;"><input type="text" value="OFFICE USE ONLY"/></p> <p>Payment method (tick applicable box):</p> <p><input checked="" type="checkbox"/> Cheque <input type="checkbox"/> Money order <input type="checkbox"/> Credit card (please complete Form C3 and attach)</p>
--	--



Do not send cash in the mail.

### Part 7 Application checklist and documentation summary

Additional information to assist in the assessment of your proposal may be attached to this application— e.g. reports on salinity, fauna or flora studies or other environmental reports conducted for the site could be included in electronic format and submitted on CDROM.

Please ensure you have included the following as part of your application:

**REQUIRED**

- A completed application form that is signed and dated by all landowners, or the applicant acting on behalf of or likely to become the landowner.
- Payment.
- An aerial photograph or map with a north arrow clearly identifying the areas of vegetation proposed to be cleared or ESRI shapefile. An ERSI shapefile must be provided if the application requires an assessment under an EPBC Act Accredited process.
- Written authority from the landowner to access the land and undertake the clearing.
- I have read and understood the 'Confidential or commercially sensitive information' section at the bottom of this form.

**REQUIRED IF APPLICABLE**

- Copy of the Certificate of Title or pastoral lease.
- Form C3 if fee is to be paid by credit card.
- Annex C7 if the clearing applied for is also to be assessed under an EPBC Act Accredited Process.

Please provide a summary of all attached documentation.

MAPS

### Part 8 Lodgement

Send by email or post original applications for all clearing purposes (other than mining and petroleum activities) to:

**Department of Environment Regulation**  
Locked Bag 33, CLOISTERS SQUARE  
PERTH WA 6850  
Email: [nvp@der.wa.gov.au](mailto:nvp@der.wa.gov.au)

Telephone: 6467 5020

For more information: [www.der.wa.gov.au/nvp](http://www.der.wa.gov.au/nvp)

Send original applications related to mining and petroleum clearing activities (under delegation) to:

**Department of Mines and Petroleum**  
Environment Division  
Mineral House  
100 Plain St  
EAST PERTH WA 6004

Telephone: 9222 3333

For more information: [www.dmp.wa.gov.au](http://www.dmp.wa.gov.au)

Please retain a copy of this form for your records.

Incomplete applications will be declined in accordance with section 51E (3) of the *Environmental Protection Act 1986*.

#### CONFIDENTIAL OR COMMERCIALY SENSITIVE INFORMATION

Information submitted as part of this application may be made publicly available. If you wish to submit information that you believe to be commercially sensitive or otherwise confidential, then you should submit that information in an appendix to this application, with a written statement of reasons why you request that each item of information be kept confidential. The department will take reasonable steps to



*Bowelling Duranillin 2018-19*



3160003 BOWELLING DURANILLIN SLK 31.09  
LAT --33.522353  
LONG 116.741477

Road No Road Name SLK  
3160003 Bowelling - Duranillin Rd 26.00  
Latitude -33.528793  
Longitude 116.700021





Darkan Moodiarrup - 2018-19

Road No Road Name SLK  
3160201 Darkan Rd 27.04  
Latitude: -33.548023  
Longitude: 116.787638

N  
↓

3160201 DARKAN RD SLK 30.7  
LAT -33.575488  
LONG 116.799826

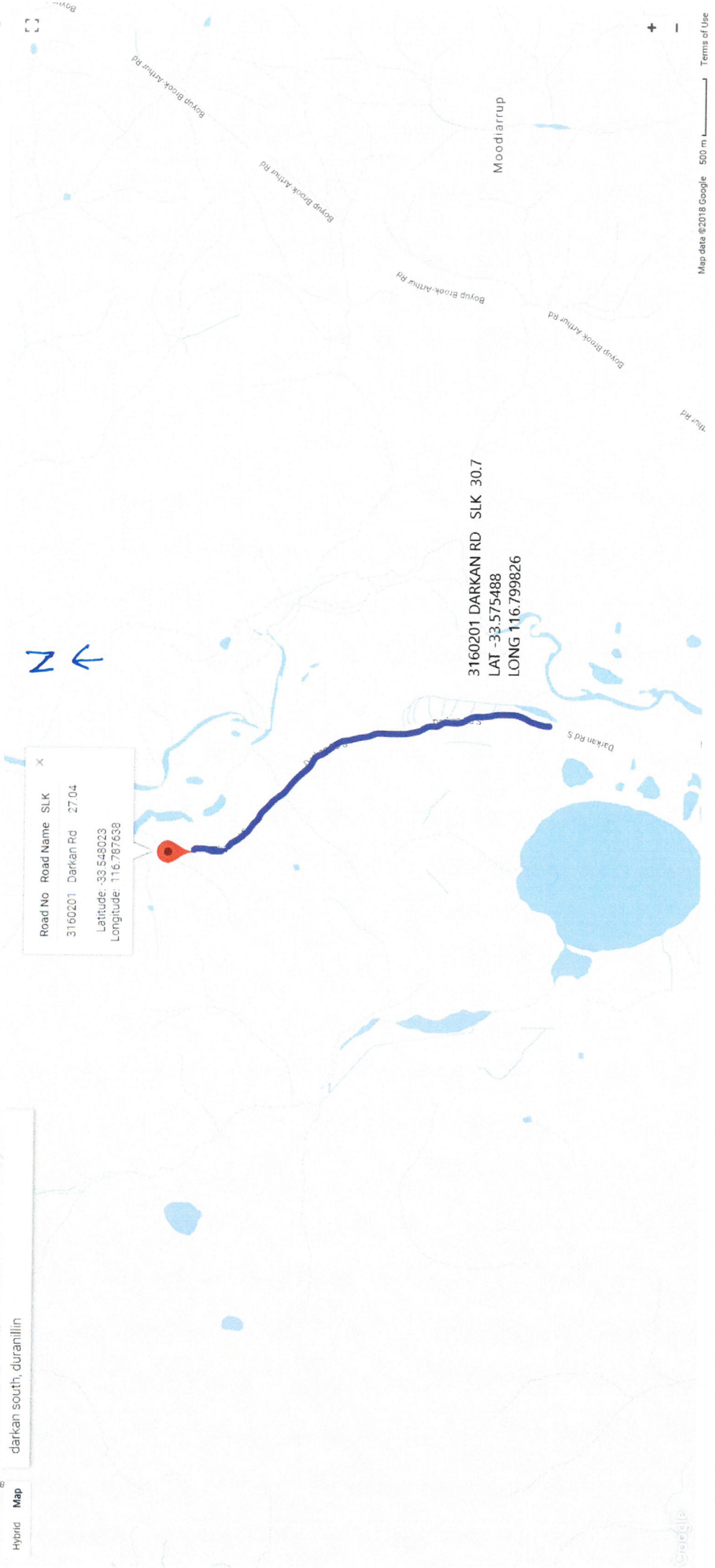





Hybrid Map | darkan south, duramillin

CAPERCUP

*Darkan Moediarup 2019-20*



Road No	Road Name	SLK
3160201	Darkan Rd	23.68
3160003	Bowelling - Duramillin Rd	36.38

Latitude: -33.520844  
Longitude: 116.796846



3160201 DARKAN RD SLK 27  
LAT -33.547673  
LONG 116.787748

Type here to search





Bowelling Duranillin 2020-21

Hybrid Map | darkan south, duranillin

Tools:

N ↖

Road No	Road Name	SLK
3160014	Capercup South Rd	0.02
3160003	Bowelling - Duranillin Rd	31.09
3160012	Capercup North Rd	15.00

Latitude: -33.522537  
Longitude: 116.741563

3160003 BOWELLING DURANILLIN SLK 36.37  
LAT -33.520783  
LONG 116.796752





Williams Darkan 2022-23

Road No	Road Name	SLK
4300128	Williams-Darkan Rd	25.50
3160207	Williams Darkan Rd	9.99

Latitude -33.255290  
Longitude 116.779143

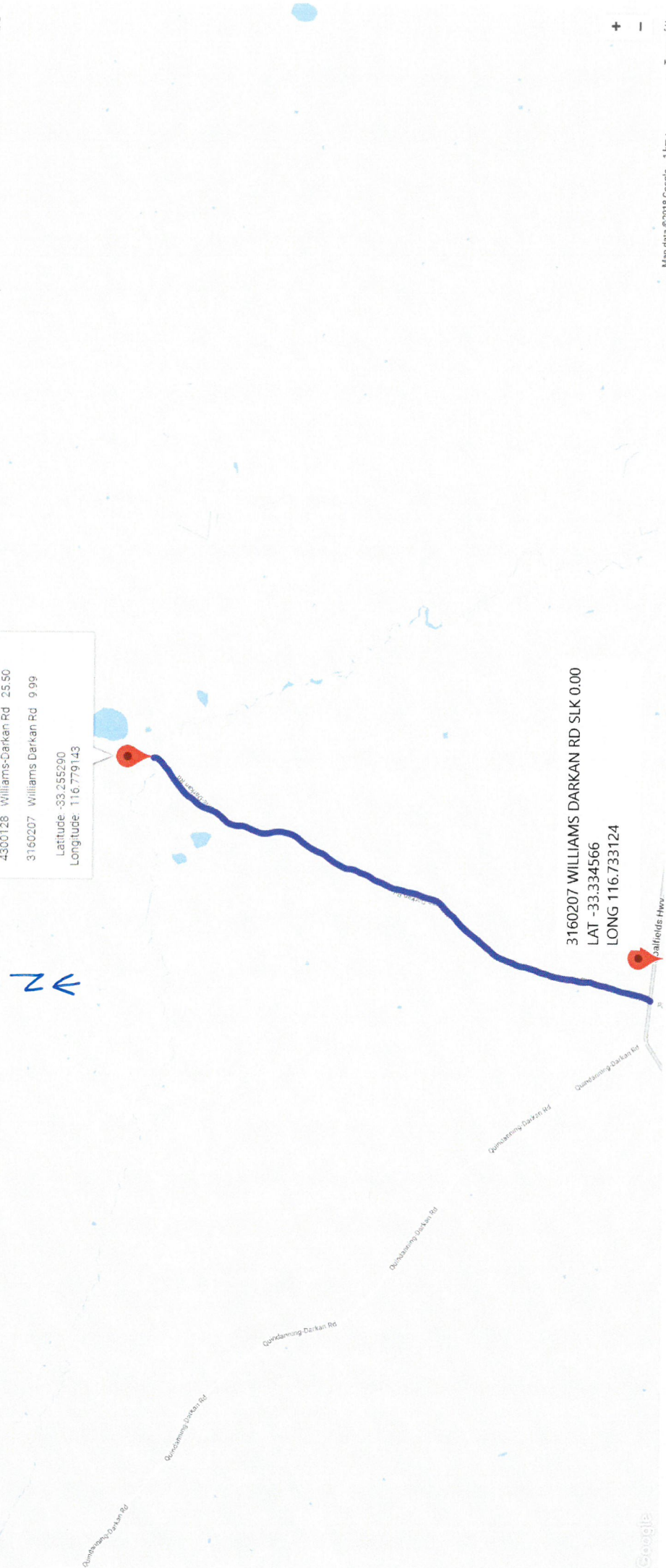

3160207 WILLIAMS DARKAN RD SLK 0.00  
LAT -33.334566  
LONG 116.733124